



ShowingBeacon.com

## Easy Set-Up Instructions

With the push of a button, notify home sellers that the showing appointment is complete and to return home.

### SHOWING BEACON™ BOX CONTENTS:

- Showing Beacon™ (blue)
- Base Unit (blue)
- (4) AA Batteries
- Phone Line
- Instruction Sheet
- Placard (graphic sign)
- Door Hanger (graphic sign)

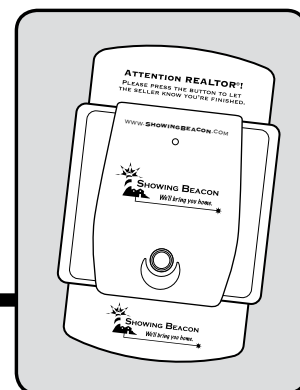

### STEP 1:

#### BATTERIES AND PLACEMENT

- A.** Install the AA batteries in the Base Unit and Showing Beacon™

**Note:** The batteries for the Base Unit cannot be replaced without removing the incoming and outgoing phone cords. To remove the cords and the batteries, slide the battery compartment cover toward the edge of the Base Unit. In the forward position, the cover will depress the levers holding the phone cords into place and allow them to be gently pulled out of the Base Unit. Once the cords are removed, slide the cover forward and remove the batteries.

- B.** Place the Showing Beacon™ in a prominent location. The Showing Beacon™ may be positioned on a horizontal or vertical surface such as an entry or kitchen table, kitchen counter or hung on the inside entry door knob or adjacent wall. To hang Beacon from a door knob, twist and remove the blue plastic strap from the larger opening on the end of the unit. Feed the strap over the top of the door knob and reinsert it into the opening.

**Showing Beacon™ should be within 50 feet of the Base Unit.**

- C.** Place Base Unit near a phone jack outlet.

### STEP 2:

#### PLUG BASE UNIT INTO PHONE JACK

- A.** Plug the phone line from the telephone into Base Unit. Plug the phone line from Base Unit into the phone jack. The phone line may be placed in either plug.
- B.** You should hear the Base Unit beep slowly.
- C.** Press the red button on the Beacon for the first time. This introduces the Beacon to the Base Unit. The Base Unit should stop beeping.

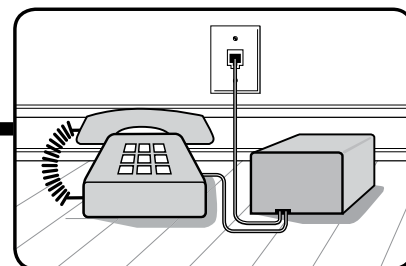

### STEP 3:

#### TEST UNIT

- A.** Push the red button on the Beacon a second time to test unit. You'll hear one long beep from the Base Unit which indicates the message was sent successfully.

### STEP 4:

#### PLACE GRAPHICS

- A. Horizontal:** If the Showing Beacon™ is placed on a table, insert the Placard (graphic) in the slot at the top of the unit. Then place the Door Hanger (graphic) on the interior entry door knob.
- B. Vertical:** If the Showing Beacon™ is hung on the wall, insert the Placard in the slot at the top edge of the unit.

### STEP 5:

#### OPERATION

Each time a showing agent presses the button on the Showing Beacon™, a call is sent to your seller's cellular phone, pager or PDA alerting them to return home.

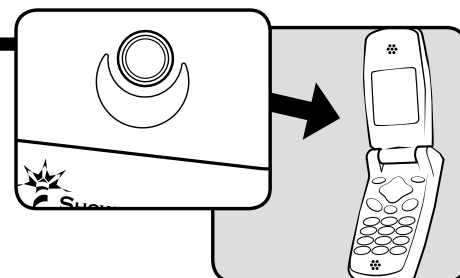

**Showing Beacon™****Full One Year Warranty**

This warranty covers the owner of this Showing Beacon™ for one year from the original purchase or ship date of the unit (which ever is later). You must keep your receipt as proof of the date of sale. This warranty covers any defects in materials or workmanship in your Showing Beacon™ with the exceptions stated below:

- fading or discoloration caused by exposure to sunlight or chemicals such as ammonia, household cleaners or bleach.
- failure to follow the operating instructions that are provided by Showing Beacon™, LLC
- improper or unauthorized repair
- fire, flood, "acts of God," or other contingencies beyond the control of Showing Beacon™, LLC

The buyer is responsible for installing and using the Showing Beacon™ according to the included directions, replace batteries as required and prevent the unit from being connected to a faulty or defective phone line.

To contact Showing Beacon™, call toll free 1-877-277-6622, or send the unit with proof of purchase and a written description of the malfunction to Showing Beacon, 8551 Bluejacket, Lenexa KS, 66214.

Showing Beacon™, LLC will repair any unit that proves to be defective in materials or workmanship. In the event repair is not possible Showing Beacon™ LLC will replace your unit with a new one.

This warranty gives you specific legal rights. You may also have other rights which vary from state to state.

---

**For assistance/troubleshooting visit [www.ShowingBeacon.com](http://www.ShowingBeacon.com) or call 877-277-6622.**

Patent Pending. Copyright 2005 Showing Beacon. All rights reserved.

---

**Warning:**

The FCC requires that you connect your cordless telephone to the nationwide telephone network through a modular telephone jack (USOCRJ11C or RJ11W). Your telephone company may discontinue your service if your equipment causes harm to the telephone network. They will notify you in advance of disconnection, if possible. During notification, you will be informed of your right to file a complaint with the FCC. If it is determined that your telephone equipment is malfunctioning, the FCC requires that it not be used and that it be unplugged from the modular jack until the problem has been corrected. Repairs to this telephone equipment can only be made by the manufacturer or its authorized agents or by others who may be authorized by the FCC. For repair procedures, follow the instructions outlined under Showing Beacon™ LLC Warranty.

The REN is useful in determining the number of devices you may connect to your telephone line and still enable the devices to ring when you receive a call. The general rule is that the REN value should not exceed 5.0 total; however, contact your local telephone company for the specific number in your area.

Changes or modifications to this unit not expressly approved by the party responsible for compliance will void the user's authority to operate the equipment. Any change to the equipment will void FCC grant.

This equipment has been tested and found to comply with the limits for a Class B digital device, pursuant to part 15 of the FCC Rules. These limits are designed to provide reasonable protection against harmful interference in a residential installation. This equipment generates, uses and can radiate radio frequency energy and, if not installed and used in accordance with the instructions, may cause harmful interference to radio communications. However, there is no guarantee that interference will not occur in a particular installation. If this equipment does cause harmful interference to radio or television reception, which can be determined by turning the equipment off and on, the user is encouraged to try to correct the interference by one or more of the following measures:

- Reorient or relocate the receiving antenna.
- Increase the separation between the equipment and receiver.
- Consult the dealer or an experienced radio/TV technician for help.

---

**IC (Industry Canada) CS03**

This device is registered for use in Canada.

**Notice:** The Industry Canada label identifies certified equipment. This certification means that the equipment meets certain telecommunications network, protective, operational and safety requirements. Industry Canada does not guarantee the equipment will operate to the user's satisfaction. Before installing this equipment, users should ensure that it is permissible to be connected to the facilities of the local telecommunications company. The equipment must also be installed using an acceptable method of connections. The customer should be aware that compliance with the above conditions may not prevent degradation of service in situations. Repairs to certified equipment should be made by an authorized Canada maintenance facility designated by the supplier. Any repairs or alterations made by the user to this equipment, or equipment malfunctions, may give the telecommunications company cause to request the user to disconnect the equipment. Users should ensure for their own protection that the electrical ground connections of the power utility, telephone lines and internal metallic water pipe system, if present, are connected together. This precaution may be particularly important in rural areas.

**Caution:** Users should not attempt to make such connections themselves, but should contact appropriate electric inspection authority, or electrician, as appropriate.

**Notice:** The REN assigned to this device denotes the number of devices you may connect to the telephone loop which is used by the device to prevent overloading. The termination on a loop may consist of any combination of devices subjected only to the requirement that the sum of the REN does exceed five (5.0).

**IC RSS210 Warning Statement:**

This device complies with RSS-210 of Industry Canada. Operation is subject to the following two conditions:

(1) this device may not cause interference, and (2) this device must accept any interference, including interference that may cause undesired operation of the device.